

How many volts does a 265w photovoltaic panel have



Overview

A 265W solar panel typically has a nominal voltage output that ranges from 35V to 40V when operating under ideal conditions. This voltage range ensures that the panel can efficiently convert solar. This is your typical voltage we put on solar panels; ranging from 12V, 20V, 24V, and 32V solar panels. 66 per watt, as most manufacturers have discontinued production in favor of higher wattage panels (400W+). 2 kW system produces 1,200 watts. In simple terms, it shows how much energy is available to push the current through the system.

How many volts does a 265w photovoltaic panel have



Watts to Volts Calculator for Solar Power Systems

In this guide, we will walk you through the process of converting watts to volts, offer real-world examples, and explain how this knowledge is crucial for solar panel installations.

How Many Volts Does a Solar Panel Put Out: Key Insights

Understanding how many volts a solar panel puts out is essential for homeowners, installers, and anyone interested in solar energy. This knowledge helps in selecting the right solar ...

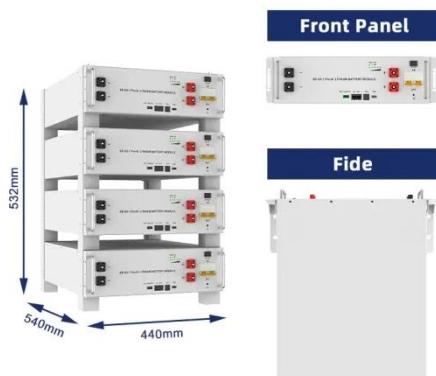

MANY Definition & Meaning , Dictionary

MANY definition: constituting or forming a large number; numerous. See examples of many used in a sentence.

Many - meaning, definition, etymology, examples and more -- Self

Explore the word "many" in detail, including its origins, variations, and common phrases. Learn about its historical and contemporary usage, as well as its impact on language and culture.



many , Dictionaries and vocabulary tools for English

many or much? Many is used with words for things that we can count. Much is used with words for things that we cannot count. Compare: Do you have many things to do today? Do you have much ...

Solar Panel Voltage Calculator, Formula, Panel Volts Calculation

It represents the total voltage output of a series-connected array of solar panels. This voltage is important because it influences both the efficiency of energy conversion and compatibility with other

...



Solar Panel Voltage Calculator



Let's assume the following values: Using the formula: $V = 550 \cdot 12 \cdot 45.8$ $V = 550 \cdot 12 \cdot 45.8$ V. The output voltage is approximately 45.8 volts under standard test conditions.

MANY Definition & Meaning

The meaning of MANY is consisting of or amounting to a large but indefinite number. How to use many in a sentence.



OEM service

Hot Colors:



Color can be customized
more questions just do not hesitate to contact us

LOGO Position: (Screen printing)



265 Watt Solar Panel Guide 2025: Specs, Prices & Best Models

Complete guide to 265W solar panels including specifications, pricing, top models from LG, Canadian Solar & more. Expert reviews & buying advice for 2025.

MANY , English meaning

We use many to refer to a large number of something countable. We most commonly use it in questions and in negative sentences: ...

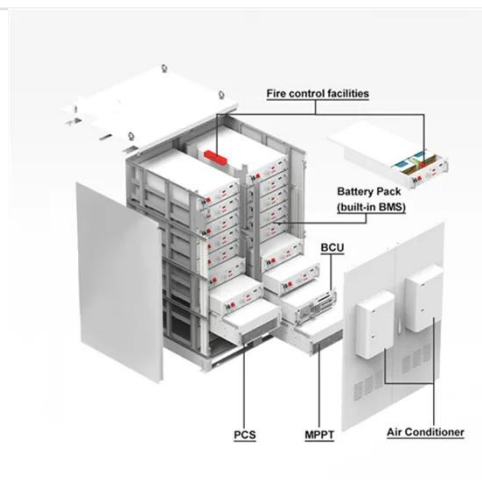
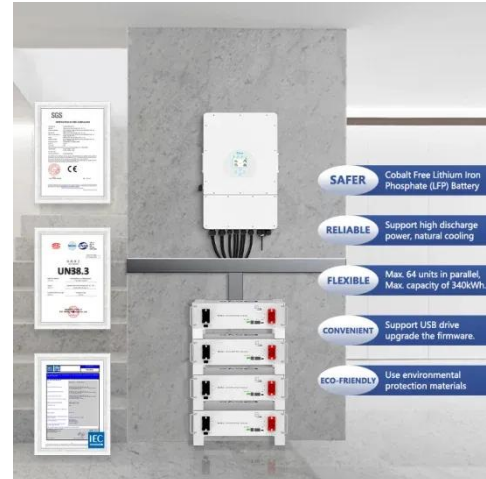

What Voltage My Solar Panel Produces (Calculations + Examples)

The voltage of a solar panel is the result of individual solar cell voltage, the number of those cells, and how the cells are connected within the panel. Every cell and panel has two voltage ...

MANY definition and meaning , Collins English Dictionary

You use many to indicate that you are talking about a large number of people or things. I don't think many people would argue with that. Not many films are made in Finland. Do you keep many books ...



Solar Panel Output Voltage: How Many Volts Do PV Panel Produce?

To be more accurate, a typical open circuit voltage of a solar cell is 0.58 volts (at 77°F or 25°C). All the PV cells in all solar panels have the same 0.58V voltage. Because we connect them in series, the ...



What is the voltage of a 265w photovoltaic panel

What is the voltage output of a solar panel? The voltage output of a single solar cell under Standard Test Conditions (STC) is approximately 0.5 volts. To increase the overall voltage, these cells are ...



How many volts is a 265w solar panel

A 265W solar panel typically has a nominal voltage output that ranges from 35V to 40V when operating under ideal conditions. This nominal voltage may vary depending on several factors, ...

Many Definition & Meaning

Many definition: Amounting to or consisting of a large indefinite number.

DISTRIBUTED PV GENERATION + ESS

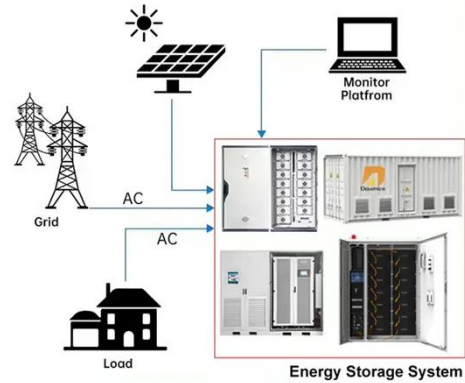

265 Watt Solar Panel: The Smart Investment for Reliable, Long ...



Typically for a 265 Watt Solar Panel, you might see Voc values around 36-38 volts. This is the current produced when the panel is short-circuited under standard test conditions. You can ...

Contact Us

For catalog requests, pricing, or partnerships, please visit:

<https://www.59empagm.pl>

